

**NOTES:**

1. TRUCK HAUL ROUTE FROM THE ARCOSA RYE BORROW PIT TO THE CONSTRUCTION SITE WILL INCLUDE U.S. AND STATE HIGHWAYS FROM THE BORROW SITE TO THE PROJECT LOCATION AND WILL ACCESS THE PROJECT SITE VIA N BAY SHORE DR. WHEN THE TRUCK OFFLOADS MATERIAL, THE HAUL ROUTE SHALL BE LOCATED AS HIGH ON THE UPPER BEACH AS PRACTICABLE.

CHAMBERS COUNTY  
CITY OF LA PORT PARKS & REC.  
MAIL: 1322 S BROADWAY, LA  
PORTE, TEXAS 77571  
281-470-5136

**AECOM**  
19219 KATY FWY STE 100  
HOUSTON, TEXAS 77094  
281-646-2400

SYLVAN BEACH HARVEY  
REPAIR PROJECT

**VICINITY AND OVERALL  
PROJECT LOCATION**

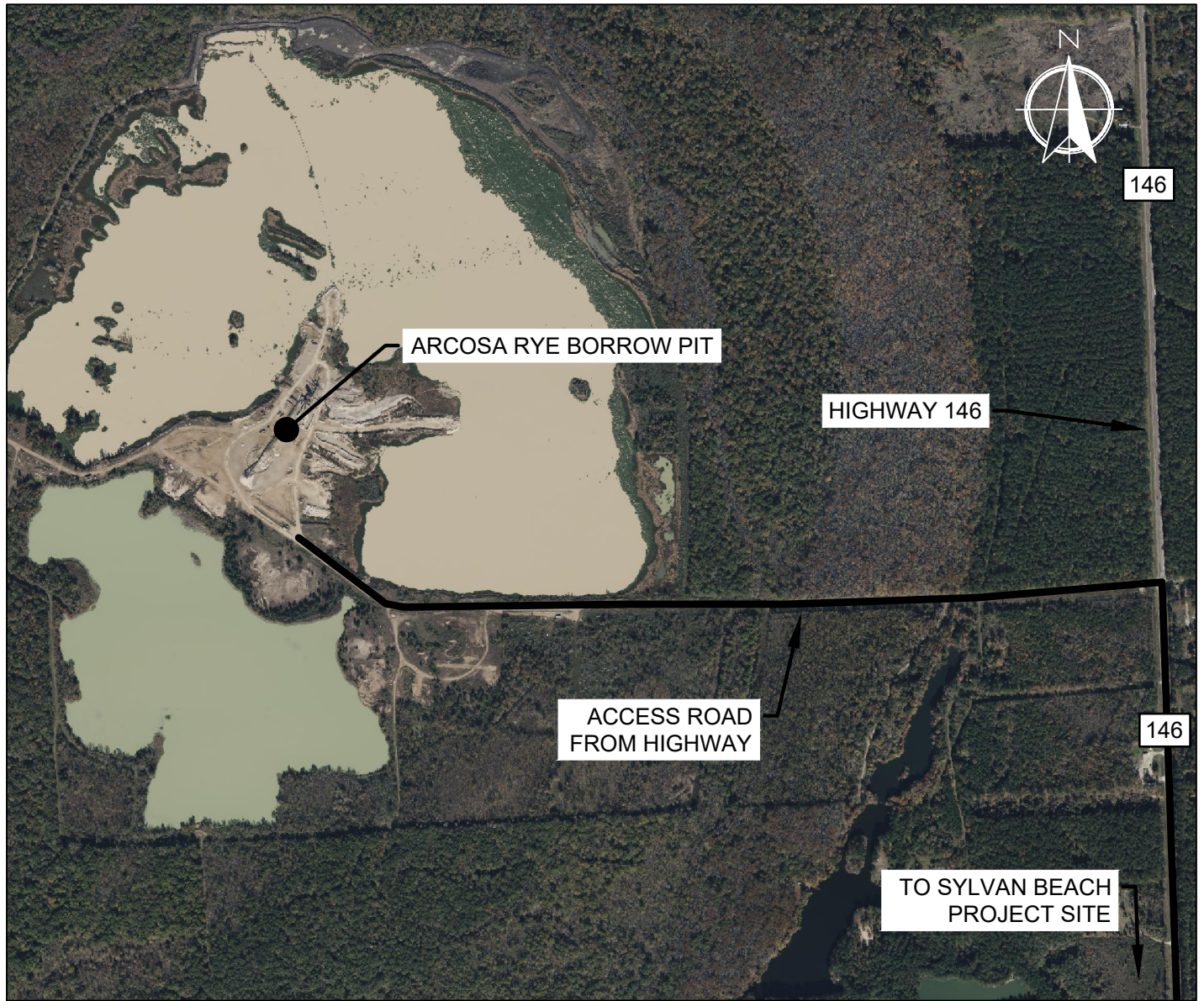

FIGURE NO.

1



0 1000 2,000  
APPROXIMATE SCALE IN FEET

LEGEND

-  HAUL ROUTE
-  HIGHWAY

**NOTES:**

1. ARCOSA RYE BORROW PIT ADDRESS IS LOCATED AT NORTH, 28125 HIGHWAY 146, CLEVELAND, TX 77327

CHAMBERS COUNTY  
CITY OF LA PORT PARKS &  
REC.  
MAIL: 1322 S BROADWAY, LA  
PORTE, TEXAS 77571  
281-470-5136

**AECOM**  
19219 KATY FWY STE 100  
HOUSTON, TEXAS 77094  
281-646-2400

SYLVAN BEACH HARVEY  
REPAIR PROJECT

**ARCOSA RYE BORROW  
PIT SITE**

FILE NO.



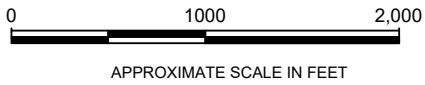

FIGURE NO.

**2**

SCALE: 1"=1000'	DRAWN BY: DCM	DATE: 5/16/2023
	CHKD. BY: TAN	DATE: 5/16/2023



**LEGEND**

-  SYLVAN BEACH CELLS
-  EASTERN OYSTER HISTORICAL HABITAT
-  PROPOSED PROJECT BASELINE
-  HAUL ROUTE

**NOTES:**  
1. EASTERN OYSTER REEF LOCATIONS FROM NOAA NCEI GULF OF MEXICO DATA ATLAS. (2011)

CHAMBERS COUNTY  
CITY OF LA PORT PARKS & REC.  
MAIL: 1322 S BROADWAY, LA PORTE, TEXAS 77571  
281-470-5136

**AECOM**  
19219 KATY FWY STE 100  
HOUSTON, TEXAS 77094  
281-646-2400

SYLVAN BEACH HARVEY REPAIR PROJECT

FILE NO.

SCALE: 1"=1000'	DRAWN BY: DCM	DATE: 5/16/2023
	CHKD. BY: TAN	DATE: 5/16/2023



**SITE PLAN AND COASTAL RESOURCES**

FIGURE NO.  
**3**

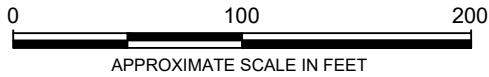
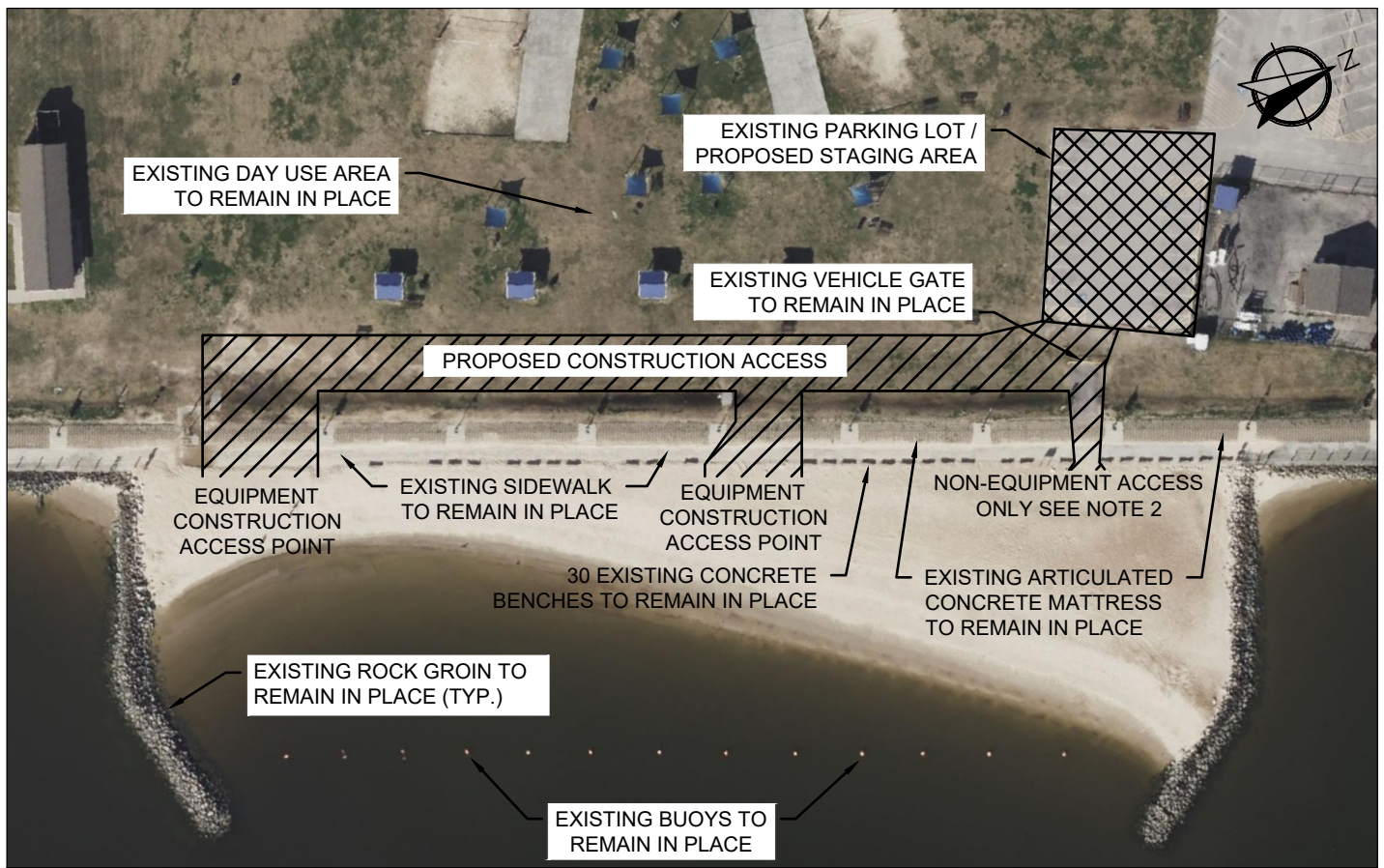
C:\Users\MoultonD\OneDrive - AECOM\Sylvan Beach\1910\_CAD\20-Sheets\01-Permitting Sheets\03 SITE PLAN.dwg



**LEGEND**

-  PROPOSED STAGING AREA
-  PROPOSED CONSTRUCTION ACCESS AREA

EXISTING SIDEWALK, ARTICULATED CONCRETE MATTRESSES, LIGHTING, TRASH CANS, STEPS, SIGNAGE, AND OTHER ANCILLARY FEATURES TO REMAIN IN PLACE

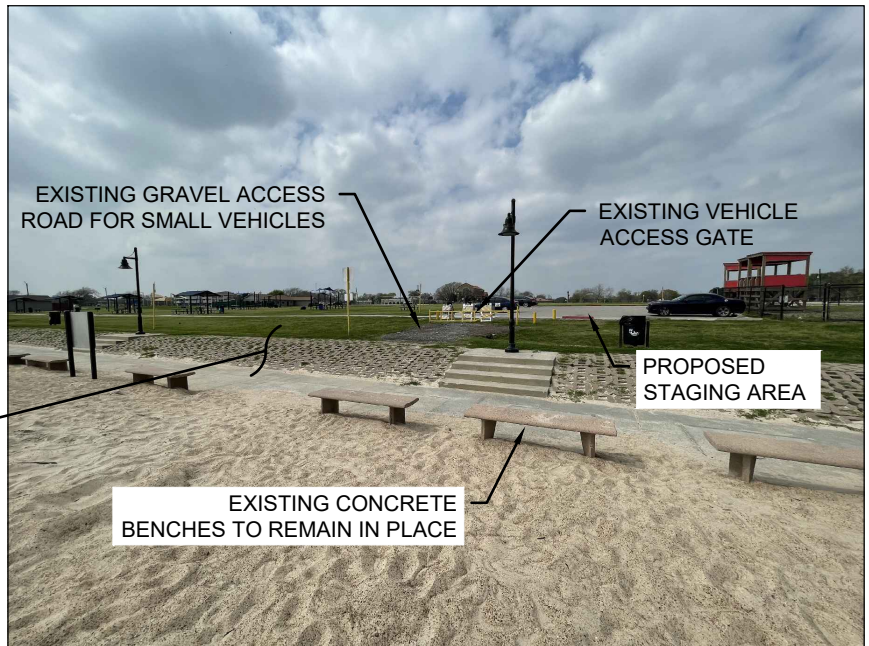

SYLVAN BEACH NORTH CELL FACING WEST

**NOTES:**

1. PROPOSED CONSTRUCTION ACCESS ROUTES ARE PROPOSED DESIGNATED AREAS TO TRANSPORT EQUIPMENT, PERSONNEL, AND MATERIALS FROM FROM THE PROPOSED STAGING AREA TO THE CONSTRUCTION SITE
2. NON-EQUIPMENT ACCESS POINTS ARE FOR SMALLER VEHICLES OR PERSONNEL ACCESS. WHILE EQUIPMENT CONSTRUCTION ACCESS POINTS CAN BE UTILIZED BY LARGER EQUIPMENT

CHAMBERS COUNTY  
CITY OF LA PORT PARKS & REC.  
MAIL: 1322 S BROADWAY, LA PORTE, TEXAS 77571  
281-470-5136

**AECOM**  
19219 KATY FWY STE 100  
HOUSTON, TEXAS 77094  
281-646-2400

SYLVAN BEACH HARVEY REPAIR PROJECT

SCALE:  
1' = 85'

DRAWN BY: DCM  
CHKD. BY: TAN

DATE: 5/16/2023  
DATE: 5/16/2023



**CONSTRUCTION SITE PLAN - NORTH CELL**

FIGURE NO.

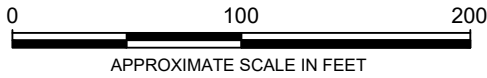
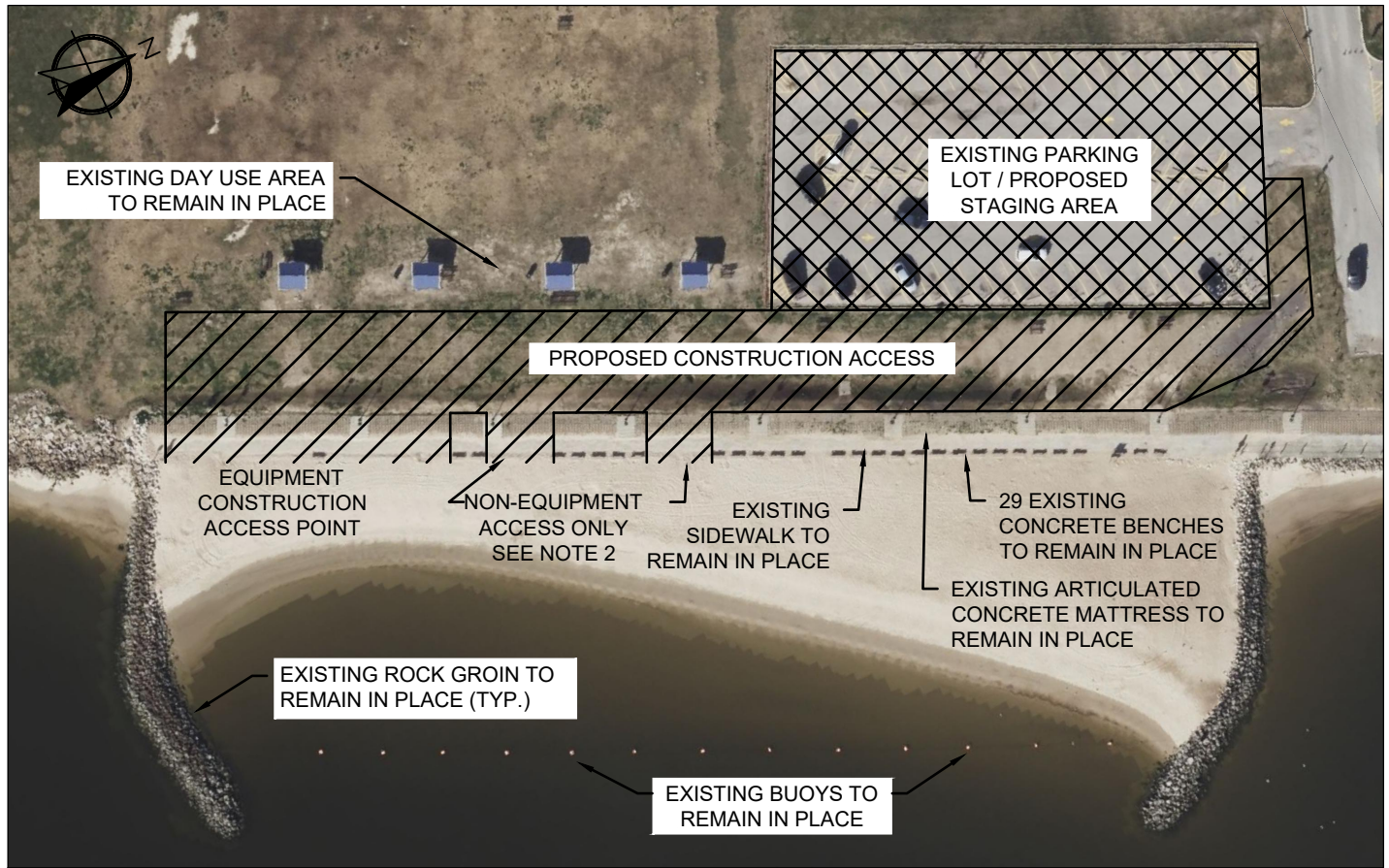
4



**LEGEND**

-  PROPOSED STAGING AREA
-  PROPOSED CONSTRUCTION ACCESS AREA



SYLVAN BEACH SOUTH CELL FACING NORTH

EXISTING SIDEWALK, ARTICULATED CONCRETE MATTRESSES, LIGHTING, TRASH CANS, STEPS, SIGNAGE, BUOYS, AND OTHER ANCILLARY FEATURES TO REMAIN IN PLACE

**NOTES:**

1. PROPOSED CONSTRUCTION ACCESS ROUTES ARE PROPOSED DESIGNATED AREAS TO TRANSPORT EQUIPMENT, PERSONNEL, AND MATERIALS FROM FROM THE PROPOSED STAGING AREA TO THE CONSTRUCTION SITE
2. NON-EQUIPMENT ACCESS POINTS ARE FOR SMALLER VEHICLES OR PERSONNEL ACCESS, WHILE EQUIPMENT CONSTRUCTION ACCESS POINTS CAN BE UTILIZED BY LARGER EQUIPMENT

CHAMBERS COUNTY  
CITY OF LA PORT PARKS & REC.  
MAIL: 1322 S BROADWAY, LA PORTE, TEXAS 77571  
281-470-5136

**AECOM**  
19219 KATY FWY STE 100  
HOUSTON, TEXAS 77094  
281-646-2400

SYLVAN BEACH HARVEY REPAIR PROJECT

SCALE:  
1' = 85'

DRAWN BY: DCM  
CHKD. BY: TAN

DATE: 5/16/2023  
DATE: 5/16/2023

**CONSTRUCTION SITE PLAN - SOUTH CELL**

FIGURE NO.

**5**

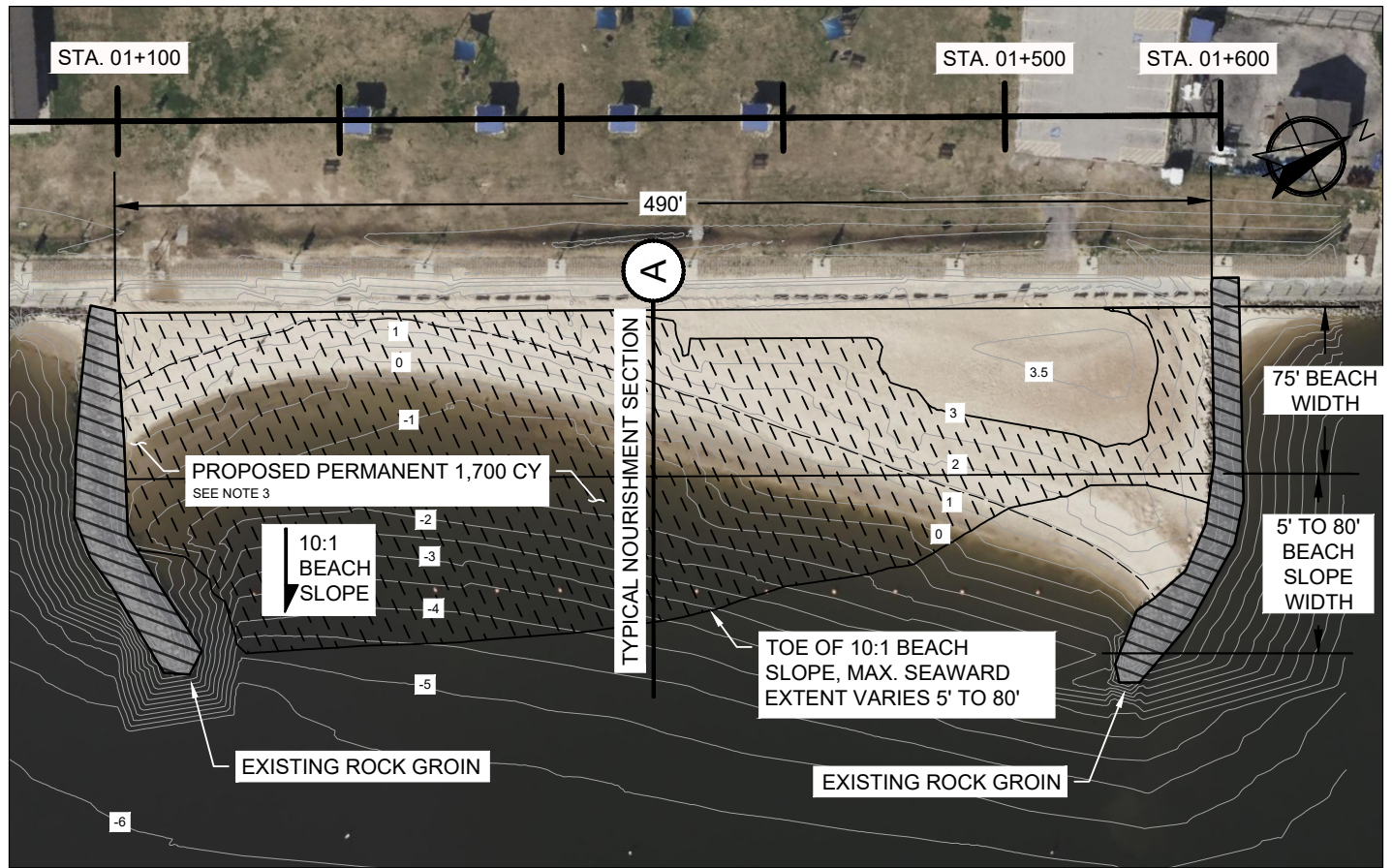

0 100 200  
APPROXIMATE SCALE IN FEET

**LEGEND**

- 3 — CONTOURS (0.5 FT INTERVALS)
- EXISTING GROIN
- PROPOSED BEACH FILL AREA
- PROPOSED PROJECT BASELINE
- MHHW 1.25' NAVD88

NORTH CELL COORDINATES			
UPPER LEFT	LOWER LEFT	UPPER RIGHT	LOWER RIGHT
29.654572° N, 95.008356° W	29.654328° N, 95.07792° W	29.655804° N, 95.007658° W	29.655560° N, 95.007093° W

**NOTES:**  
 1. BEACH CELL COORDINATES ARE GIVEN IN DECIMAL DEGREES.  
 2. DIMENSIONS ARE APPROXIMATE AND WILL BE FINALIZED DURING DESIGN.  
 3. BEACH FILL DIMENSIONS, 75' WIDTH TYP. BERM WITH MIN. ELEVATION OF +3.0' (NAVD88), AND 10:1 SLOPE 5' TO 80' SEAWARD, TO MATCH TYP. ORIGINAL BEACH CONSTRUCTION SPECIFICATIONS AND MATERIAL QUANTITY.  
 4. MHHW AND CONTOURS SURVEYED BY NAISMITH MARINE SERVICES (NOW T.BAKER SMITH) ON 6/15/2022

CHAMBERS COUNTY  
CITY OF LA PORT PARKS & REC.  
MAIL: 1322 S BROADWAY, LA PORTE, TEXAS 77571  
281-470-5136

**AECOM**  
19219 KATY FWY STE 100  
HOUSTON, TEXAS 77094  
281-646-2400

SYLVAN BEACH HARVEY REPAIR PROJECT

SCALE: 1' = 85'	DRAWN BY: DCM	DATE: 5/16/2023
	CHKD. BY: TAN	DATE: 5/16/2023

**SITE PLAN - NORTH CELL**

FIGURE NO.  
**6**

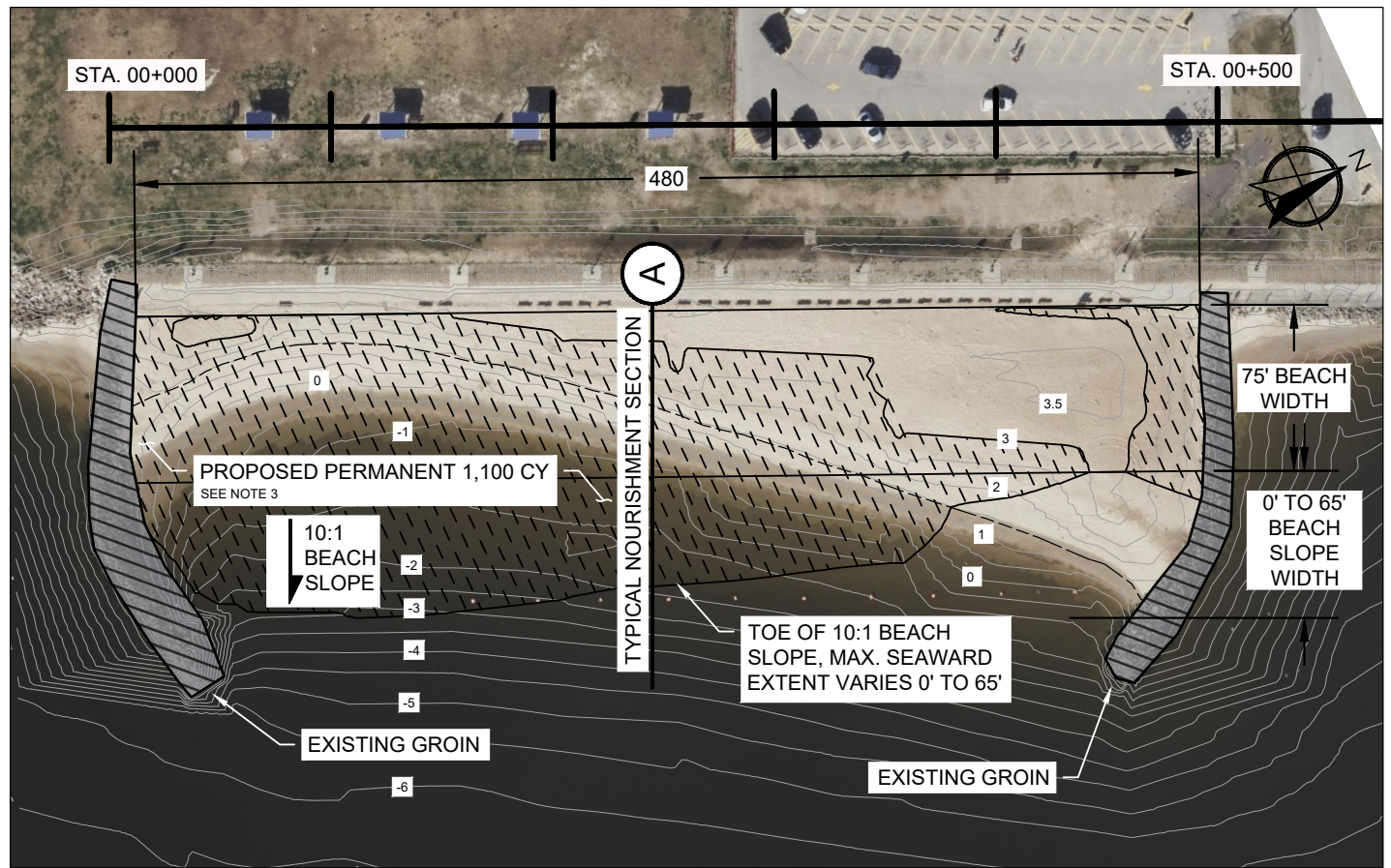

**LEGEND**

- 3 —      CONTOURS  
(0.5 FT INTERVALS)
- EXISTING GROIN
- PROPOSED BEACH  
FILL AREA
- PROPOSED  
PROJECT BASELINE
- MHHW 1.25' NAVD88

SOUTH CELL COORDINATES			
UPPER LEFT	LOWER LEFT	UPPER RIGHT	LOWER RIGHT
29.651869° N, 95.009324° W	29.651628° N, 95.009324° W	29.653105° N, 95.009200° W	29.652865° N, 95.008634° W

**NOTES:**

1. BEACH CELL COORDINATES ARE GIVEN IN DECIMAL DEGREES.
2. DIMENSIONS ARE APPROXIMATE AND WILL BE FINALIZED DURING DESIGN.
3. BEACH FILL DIMENSIONS, 75' WIDTH TYP. BERM WITH MIN. ELEVATION OF +3.0' (NAVD88) , AND 10:1 SLOPE 5' TO 80' SEAWARD, TO MATCH TYP. ORIGINAL BEACH CONSTRUCTION SPECIFICATIONS AND MATERIAL QUANTITY.
4. MHHW AND CONTOURS SURVEYED BY NAISMITH MARINE SERVICES (NOW T.BAKER SMITH) ON 6/15/2022

CHAMBERS COUNTY  
CITY OF LA PORT PARKS &  
REC.  
MAIL: 1322 S BROADWAY, LA  
PORTE, TEXAS 77571  
281-470-5136

**AECOM**  
19219 KATY FWY STE 100  
HOUSTON, TEXAS 77094  
281-646-2400

SYLVAN BEACH HARVEY  
REPAIR PROJECT  
**SITE PLAN - SOUTH CELL**

FIGURE NO.  
**7**

C:\Users\MoutonD\OneDrive - AECOM\Sylvan Beach\910\_CAD\20-Sheets\01-Permitting Sheets\CELLS\_AND\_TYP\_SECTION.dwg

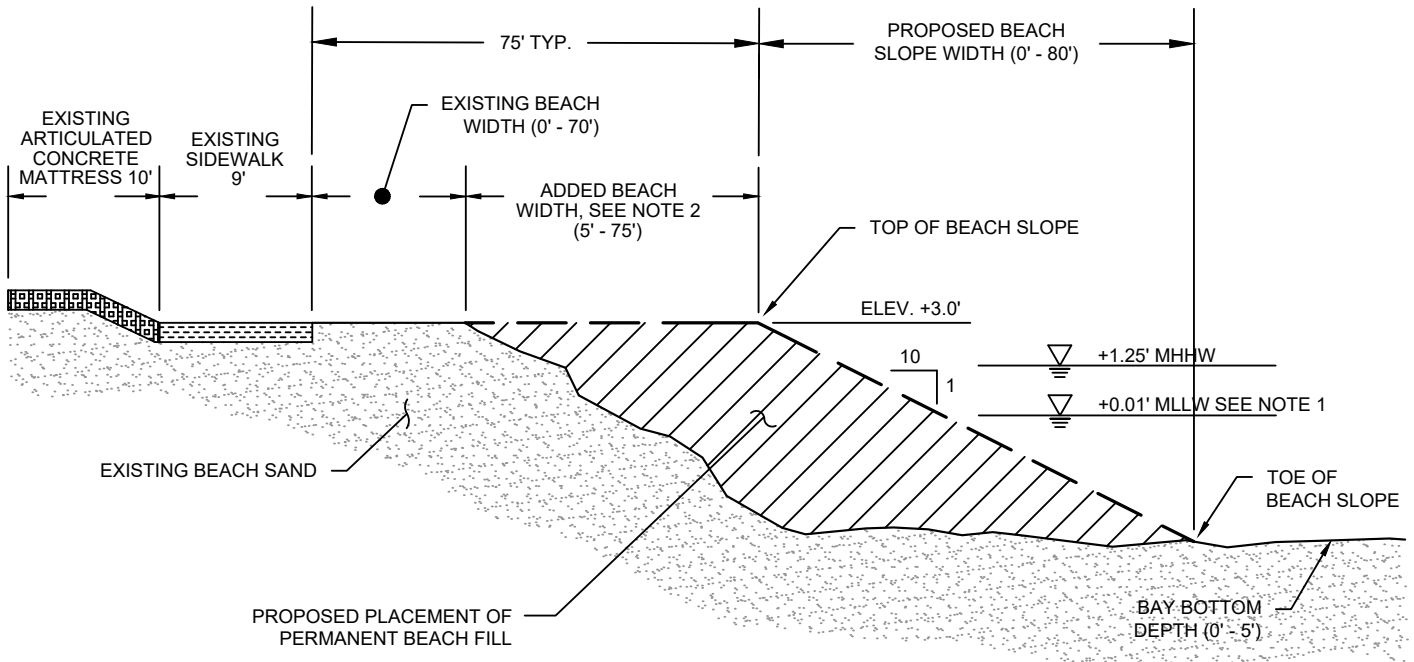

# TYPICAL NOURISHMENT SECTION

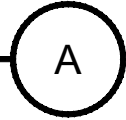

NTS

PERMANENT FILL QUANTITIES	
NORTH CELL	1,700 CY
SOUTH CELL	1,100 CY

- NOTES:**
1. MLLW ELEVATION IN FEET NAVD 88 AS ESTABLISHED FROM DATUM AT THE MORGAN'S POINT, BARBOURS CUT TIDE GAUGE STATION (ID# 8770613).
  2. ADDED BEACH WIDTH VARIES TO MATCH PRE-STORM FILL DIMENSIONS ( TYP. 75' MIN. BEACH WIDTH) AND QUANTITIES.

CHAMBERS COUNTY  
CITY OF LA PORT PARKS &  
REC.  
MAIL: 1322 S BROADWAY, LA  
PORTE, TEXAS 77571  
281-470-5136

**AECOM**  
19219 KATY FWY STE 100  
HOUSTON, TEXAS 77094  
281-646-2400

SYLVAN BEACH HARVEY  
REPAIR PROJECT

SCALE: NTS	DRAWN BY: DCM CHKD. BY: TAN	DATE: 5/16/2023 DATE: 5/16/2023
---------------	--------------------------------	------------------------------------

**TYPICAL SECTION**

FIGURE NO. <b>8</b>
------------------------

C:\Users\MoultonD\OneDrive - AECOM\Sylvan Beach\1910\_CAD\20-Sheets\01-Permitting Sheets\CELLS\_AND\_TYP\_SECTION.dwg